

Reviving Calverley Old Hall

Developing a repair approach which felt appropriate for Calverley Old Hall was not an easy task. So many changes had been made to the building in its lifetime, it would have been impossible to restore the building to a specific time period. In order to maintain the multi-layered history of the building, elements of the cottages have been retained, alongside incorporating and respecting the original medieval features of Calverley Old Hall.

DESIGN COMPETITION

In 2018 Landmark held an international design competition, inviting architects from across the globe to submit their ideas for the re-use of Calverley Old Hall. Over 70 applications were received, each providing a new idea for the building's future. The winning design came from Cowper Griffith Architects of Cambridge, who designed a scheme which both respects the historic nature of Calverley Old Hall whilst also allowing a more contemporary re-use of the building.

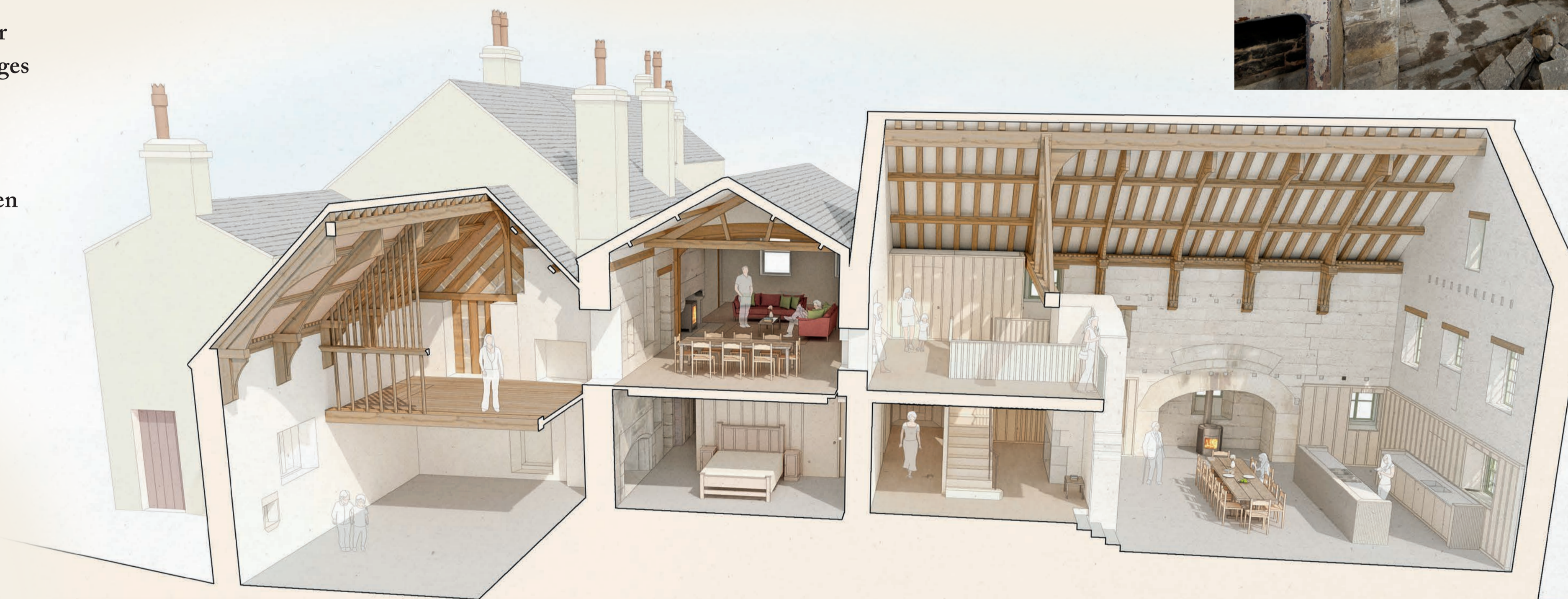

Above: The Great Hall with partial remains of the previous cottages prior to repair.

Left: The chosen scheme, designed by Cowper Griffith Architects.



SUSTAINABILITY

A key part of the project has been to make Calverley Old Hall more sustainable and environmentally friendly. This has included fitting a new ground source heating system, retaining and reusing as much original material as possible throughout the process, insulating to minimise heat loss, and using building materials which are as environmentally friendly as possible. Skilled craftspeople who use traditional building techniques were employed throughout the repair works, with care taken to use traditional materials to ensure the building remains in the best condition possible for years to come.

A few highlights of the project

2021: The roof was lifted and repaired where needed, revealing the first of many concealed finds.

The Painted Chamber was first glimpsed beneath early 20th century lath and plaster.

2022: The semi-derelict cottages in the Great Hall had been partially stripped out in the 1980s, and now remaining chimney breasts were also removed. The 17th century dividing wall between the Great Hall and Solar Block was lowered, creating a gallery area which provides a high-level view into the Great Hall.

The upper floor was reinstated in the Solar Block and formerly blocked doorways were reopened, to provide

full access through the building once again. Underfloor heating was introduced in the building, powered by a ground source heating system, with six boreholes drilled into the garden to a depth of 143 metres.

2023: A lift was introduced to improve accessibility within this historic building, and a level-access bedroom and bathroom was created in the Solar Block.

2024: The wall paintings were fully revealed and conserved.

The landscaping and furnishing were completed, and guests were able to stay in the building for the first time.

Drilling the 143 metres-deep boreholes for the ground source heating system.



Scan for an audio version of this information

www.landmarktrust.org.uk/calverley

Scan for further information about Calverley Old Hall and its repair and conversion

